

16BHC

WEIGHT 3010

LENGTH 20' 2"

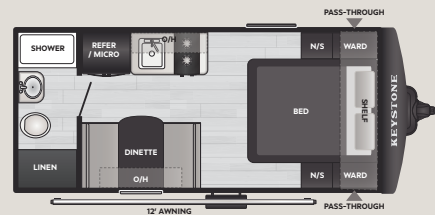

16RBC

WEIGHT 2995

LENGTH 20' 5"

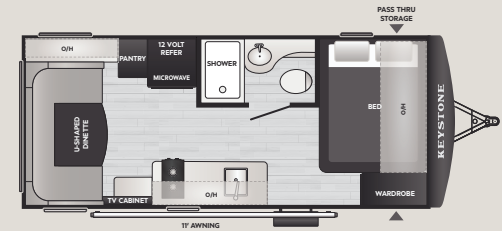

19RDC

WEIGHT TBD

LENGTH 21' 11"

SINGLE AXLE

DUAL AXLE

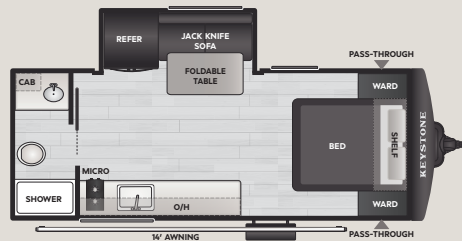

18RBC

WEIGHT 4050

LENGTH 22' 4"

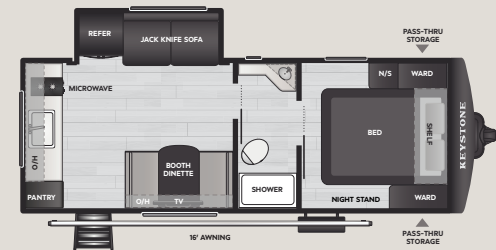

21RKC

WEIGHT 4635

LENGTH 25' 5"

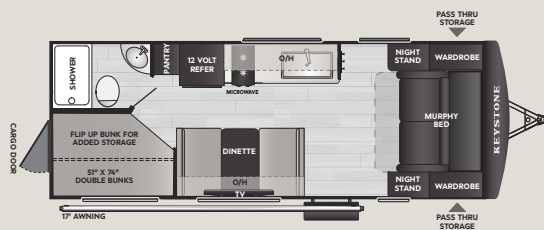

21BHC

WEIGHT 4280

LENGTH 25' 4"

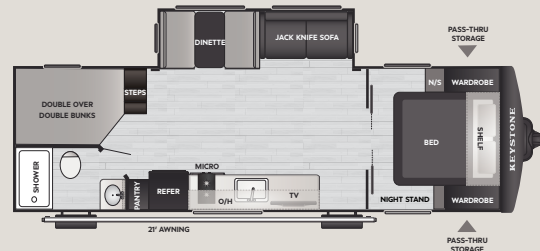

26BHC

WEIGHT 5320

LENGTH 30' 4"

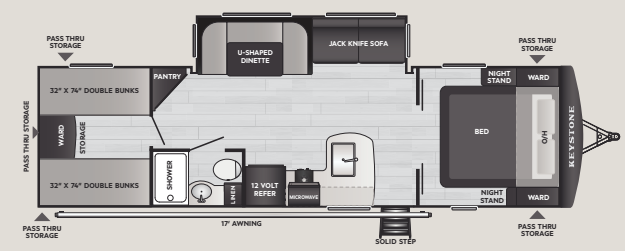

28QBC

WEIGHT 5865

LENGTH 32' 9"



STANDARD FEATURES & OPTIONS

INTERIOR

- ♦ **NEW** Custom Metal Window Valances
- ♦ **NEW** Solarium Skylight Above Every Shower and Tub (SELECT FLOORPLANS)
- ♦ **NEW** Upgraded Shower Head
- ♦ **NEW** Upgraded Retractable Shower Door
- ♦ **NEW** Large LED TV ((SELECT FLOORPLANS)
- ♦ **NEW** Adult Rated Bunks up to 500 lbs. w/Secret Sleeper Storage
- ♦ **NEW** Convection, Air Fryer, Combo Microwave
- ♦ **NEW** Queen Bed w/Secret Sleeper Storage (SELECT FLOORPLANS)
- ♦ **NEW** 1-Piece Shower Surround
- ♦ **NEW** Windows in Slide Wall Ends
- ♦ **NEW** Premium Aluminum Wheels
- ♦ Tranquil Timber Interior Decor
- ♦ Deluxe Night Shades
- ♦ Residential-Style Bathroom Countertops
- ♦ LED Lighting Throughout
- ♦ Large French Door 12V Refrigerator
- ♦ 2-Burner High Output Range (SINGLE AXLE MODELS ONLY)
- ♦ 3-Burner High Output Range W/Stove (DUAL AXLE MODELS ONLY)
- ♦ Large 12V Double Door Refrigerator
- ♦ 15K BTU A/C
- ♦ Interior Control Panel

EXTERIOR

- ♦ **NEW** (4) 3K LBS. 24" Manual Stabilizer Jacks w/ Quick Drop Bit Attachment
- ♦ **NEW** Keyed A-Like Locking System
- ♦ **NEW** Oversized Entry Door Grab Handle
- ♦ **NEW** Glass Entry Door Featuring Built-In Shade Privacy System
- ♦ **NEW** LP Tank Cover & Upgraded LP Regulator
- ♦ **NEW** LP Quick Connect Hook Up (Dual Axle)
- ♦ **NEW** Lippert® On-The-Go™ Ladder Prep
- ♦ **NEW** Tow Chain & 7-Way Plug Holder
- ♦ **NEW** Quick Connect Spray Port
- ♦ Hot and Cold Outdoor Shower
- ♦ Fully Walkable Roof
- ♦ 5 – Sided Aluminum Construction
- ♦ Front Edge View Exterior Lighting
- ♦ S Lock Metal Front Cap w/ Rock Guard
- ♦ Glass Entry Door Featuring Built-In Shade Privacy System
- ♦ Keyed – A – Like Locking System
- ♦ Heated and Enclosed Underbelly
- ♦ Power Awning w/LED Light Strip
- ♦ Leaf Spring Straight Axles
- ♦ 80% Tinted Safety Glass Windows
- ♦ Heated & Enclosed Underbelly
- ♦ Fully Walkable Roof
- ♦ Spare Tire
- ♦ Rear Camera Prep
- ♦ 12V Color-Coded Wiring
- ♦ SolarFlex™ Ready
- ♦ Battery Disconnect

OPTIONS

- ♦ SolarFlex™ Protect
- ♦ 2nd 13.5K BTU A/C (SELECT FLOORPLANS)