



KEYSTONE
RV COMPANY

CAMP BETTER
KINDNESS · COMMUNITY · PLANET

COUGAR

HALF-TON TRAVEL TRAILERS

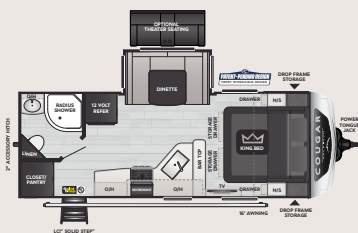

22RBS | WEIGHT 5785 | LENGTH 25' 11"

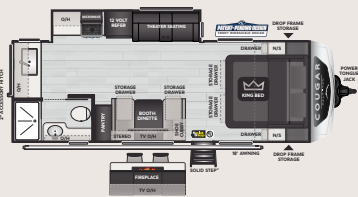

22MLS | WEIGHT 6088 | LENGTH 25' 9"

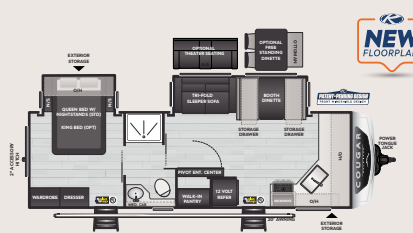

25FKD | WEIGHT 7096 | LENGTH 29' 11"

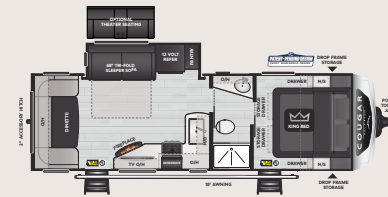

25RDS | WEIGHT 6640 | LENGTH 29' 10"

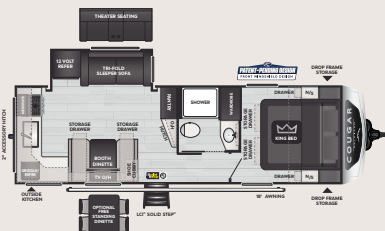

25MLE | WEIGHT 6676 | LENGTH 29' 11"

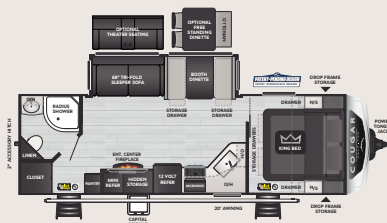

26RBS | WEIGHT 6798 | LENGTH 29' 11"

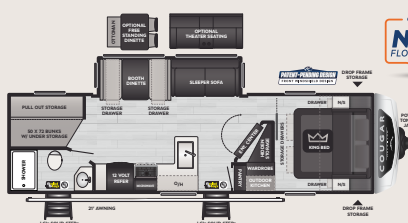

28BHS | WEIGHT 7240 | LENGTH 32' 11"

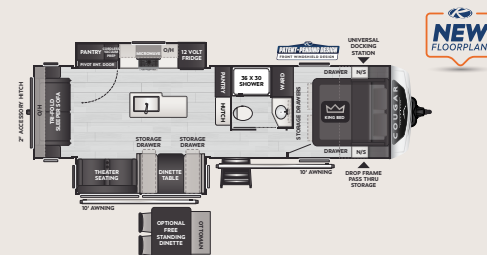

29RLP | WEIGHT 7875 | LENGTH 33' 7"

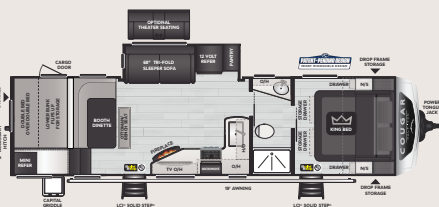

30BHS | WEIGHT 7210 | LENGTH 34' 5"

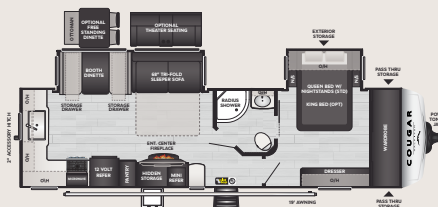

30RKD | WEIGHT 7715 | LENGTH 34' 9"

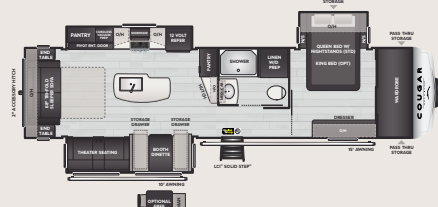

33RLI | WEIGHT 8579 | LENGTH 37' 5"

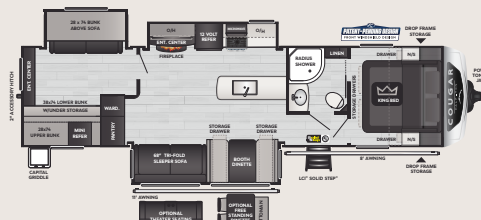

34TSB | WEIGHT 8775 | LENGTH 37' 5"

DISCLAIMER: Product information is as accurate as possible as of the date of publication of this publication. All features, floor plans, and specifications in this publication are subject to change without notice. Please also consult Keystone's web site at www.keystonerv.com for more current product information and specifications. Tow Vehicle Disclaimer. CAUTION: Owners of Keystone recreational vehicles are solely responsible for the selection and proper use of tow vehicles. All customers should consult with a motor vehicle manufacturer or their dealer concerning the purchase and use of suitable tow vehicles for Keystone products. Keystone disclaims any liability or damages suffered as a result of the selection, operation, use or misuse of a tow vehicle. KEYSTONE'S LIMITED WARRANTY DOES NOT COVER DAMAGE TO THE RECREATIONAL VEHICLE OR THE TOW VEHICLE AS A RESULT OF THE SELECTION, OPERATION, USE OR MISUSE OF THE TOW VEHICLE. *Length is defined as the distance from the centerline of hitch pin/coupler to rear bumper of trailer. **Fresh water capacity includes water heater. Please review owner's manual prior to purchase for more information on service warranties, extended use, towing and maintenance. Owner's manuals can be found at keystonerv.com.

VISIT OUR WEBSITE FOR PHOTOS,
360° TOURS, AND FULL PRODUCT DETAILS





KEYSTONE
RV COMPANY

CAMP BETTER
KINDNESS · COMMUNITY · PLANET

COUGAR

HALF-TON TRAVEL TRAILERS

STANDARD FEATURES & OPTIONS

UNIT

- ♦ Girard® On-Demand Water Heater
- ♦ 55 Gallon Fresh Water Tank
- ♦ Universal Docking Station - Easy Winterization
- ♦ Lippert® Solid Step® w/ Entry Door Privacy Shade
- ♦ Slide Topper Prep
- ♦ 5-Sided Aluminum Superstructure
- ♦ Alpha Ply 30 TPO Roofing w/ Lifetime Warranty
- ♦ Fully Walkable Roof and Slide-out Roof
- ♦ (2) 20 LBS. LP Tanks
- ♦ LP Quick Disconnect for Grilling
- ♦ Detachable Power Cord w/ Reverse Polarity Indicator
- ♦ Linoleum Slideout Flooring
- ♦ Dimmable Lights in Main Slideout, Living Room & Bedroom
- ♦ Blackout Rollershades Throughout
- ♦ HD Smart TV & Bluetooth Connectivity Sound System
- ♦ Winegard 360+ w/ WiFi Prep
- ♦ Furrion 17" Oven w/3-Burner Cooktop
- ♦ Single Bowl Stainless Steel Kitchen Sink w/ Sink Covers
- ♦ High Rise Kitchen Faucet w/ Pullout Sprayer
- ♦ Soft Close Cabinet Doors w/ Hidden Hinges
- ♦ Booth Dinette w/Drawers & Accent Lighting
- ♦ Under Bed Storage w/ Strut Assist
- ♦ Nightstands w/ 110 Outlets & USB Ports
- ♦ 12V USB Outlets Throughout
- ♦ Washer/Dryer Prep (33RLI ONLY)

- ♦ Memory Foam Mattress w/ Washable Cover
- ♦ Drop-Frame w/Increased Storage (SELECT FLOORPLANS)
- ♦ Vent-All Window System
- ♦ Keyed Alike
- ♦ Power Tank Fill
- ♦ Water Pump Access Panel
- ♦ Heat Duct in Pass-Through Storage
- ♦ Exterior Awning Switches

TOWING WITH CONFIDENCE

- ♦ Lippert® Axles w/ Anti-Lock Braking System
- ♦ Goodyear® Endurance® Tires
- ♦ Lippert® Road Armor™ Shock Absorbing Equalizer*
- ♦ Tire Linc® TPMS Prep
- ♦ Full Size Spare Tire
- ♦ Rear Camera Prep
- ♦ Reverse Tail Lights
- ♦ 2" Accessory Hitch

INNOVATIONS

- ♦ HyperCore™ Composite Sidewalls
- ♦ HyperDeck™ Water Resistant Flooring

- ♦ Blade™ Air Flow System
- ♦ Giggly Box-Industry's 1st Organized 12V Wiring Box
- ♦ Color-Coded & Unified Wiring System
- ♦ KeyTV™
- ♦ Tru-Fit™ Slide Construction
- ♦ Painted Front Cap w/ Automotive Clear Coat
- ♦ Automotive Windshield (SELECT FLOORPLANS)
- ♦ Decorative Snap-In Ceiling Treatments

CLIMATE GUARD PROTECTION

- ♦ 15K BTU Furrion A/C
- ♦ 30K BTU Furnace
- ♦ Tinted Windows w/ Safety Glass
- ♦ Astro-Foil™ Insulated Underbelly
- ♦ 12V Heat Pads on Holding Tanks
- ♦ Forced-Air Heated & Enclosed Underbelly
- ♦ Reflective Foil Insulated Front Cap & Slide Floors
- ♦ Dual Attic Vents
- ♦ PEX Plumbing Line

DISCLAIMER: Product information is as accurate as possible as of the date of publication of this publication. All features, floor plans, and specifications in this publication are subject to change without notice. Please also consult Keystone's web site at www.keystonerv.com for more current product information and specifications.
Tow Vehicle Disclaimer. CAUTION: Owners of Keystone recreational vehicles are solely responsible for the selection and proper use of tow vehicles. All customers should consult with a motor vehicle manufacturer or their dealer concerning the purchase and use of suitable tow vehicles for Keystone products. Keystone disclaims any liability or damages suffered as a result of the selection, operation, use or misuse of a tow vehicle. KEYSTONE'S LIMITED WARRANTY DOES NOT COVER DAMAGE TO THE RECREATIONAL VEHICLE OR THE TOW VEHICLE AS A RESULT OF THE SELECTION, OPERATION, USE OR MISUSE OF THE TOW VEHICLE. *Length is defined as the distance from the centerline of hitch pin/coupler to rear bumper of trailer. ** Fresh water capacity includes water heater. Please review owner's manual prior to purchase for more information on service warranties, extended use, towing and maintenance. Owner's manuals can be found at keystonerv.com.

VISIT OUR WEBSITE FOR PHOTOS,
360° TOURS, AND FULL PRODUCT DETAILS

